



Puertas & Portones Automaticos, S.A. de C.V.

¡Nuestra pasión es la Solución!...

MOTOR SPECIFICATIONS:

ELECTRICAL EQUIPMENT LIST:

BOTTOM BAR LOCKING:

Locking not required.

QUANTITY & MARK:

(2) 001

MATERIAL & FINISH:

Curtain - Galvanized steel with GalvaNex™ coating system.
Finish color: Gray

Bottom Bar - Aluminum, mill finish

Guides - Structural steel, Gray polyester powder coating

Hood - Galvanized steel with GalvaNex™ coating system.
Finish color: Gray

Plain Steel - Powder coated Gray

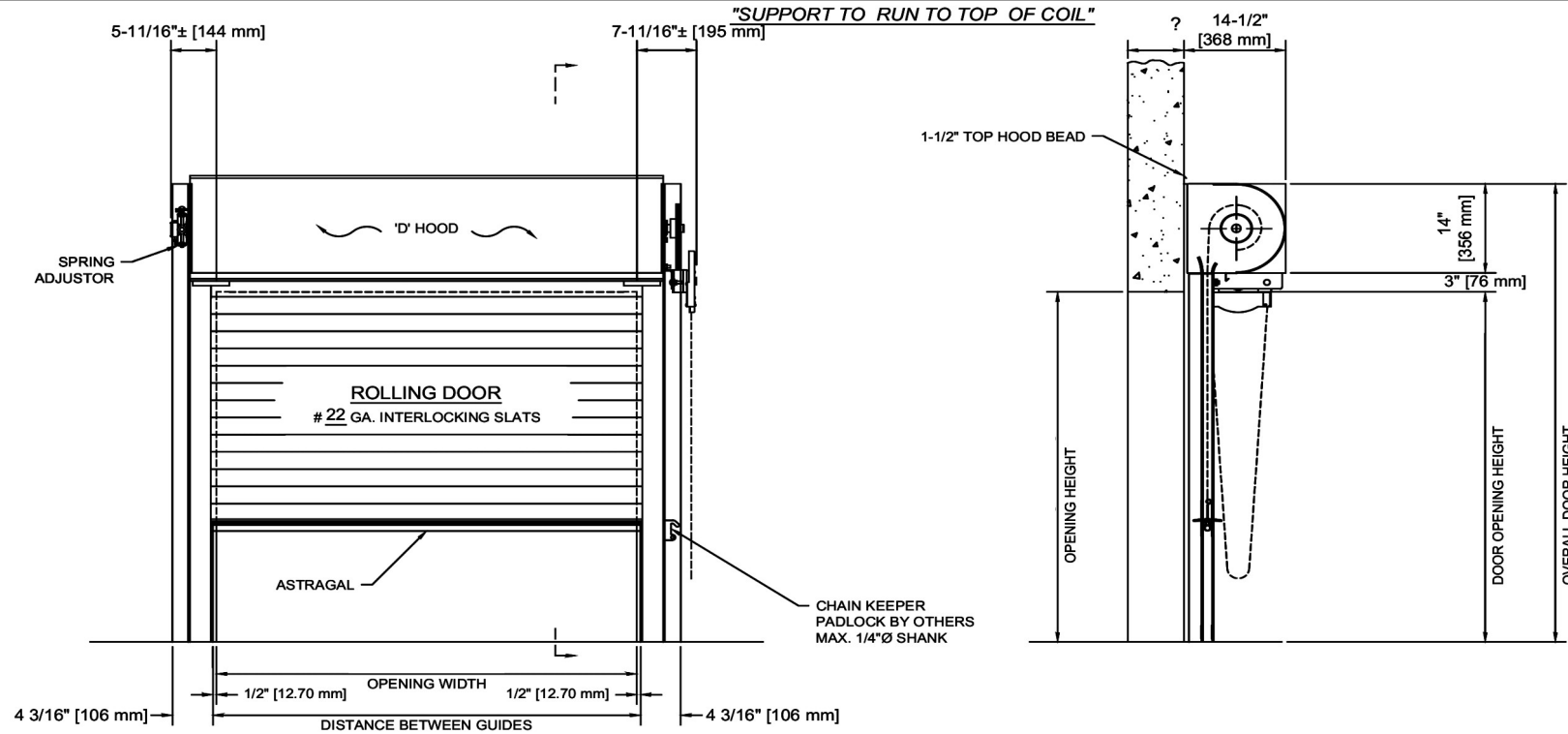

ELEVATION (COIL SIDE) AND SECTION VIEW

See drawing # E 01236316 001 B for guide detail.

03-21-2018	PRODUCT CODE:
BSE_STDR	CFI 5F 22GP

MODEL #:	JOB #:
ESD10	E 01236316 001 A

---	ORIGINAL DRAWING	06/13/18	MX
#	REVISION	DATE	BY



CONTROLGARD CHAIN OPERATED ROLLING DOOR

JOB: TO ADVISE

AGENT:	MEXICO
CONTRACTOR:	
ARCHITECT:	



RESIDENCIAL



COMERCIAL



INDUSTRIAL



(229) 365-5662

portonesautomaticos@adsver.com.mx
portonesautomaticos@prodigy.net.mx



NOTE: Wall construction detail shown is for illustrative purposes only, does not imply compliance with building requirements, and must meet architectural specifications to properly support product. Products designed with wind load requirements must be properly fastened to structural members as specified in order to avoid catastrophic failure. Wall construction and closure installation shall be in accordance with the local authority having jurisdiction requirements.

Puertas & Portones Automaticos, S.A. de C.V.
¡Nuestra pasión es la Solución!....

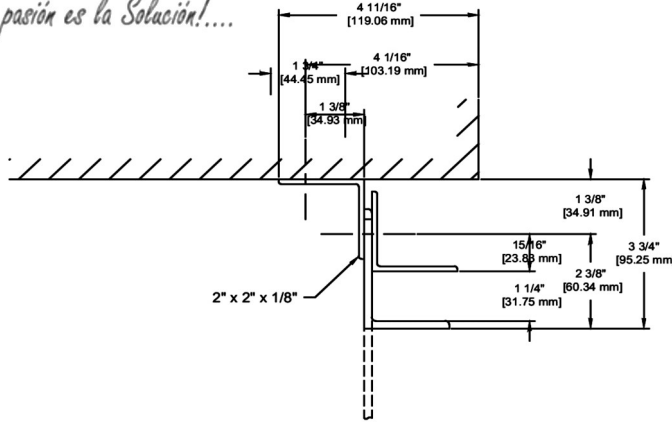

GA0351 - 3 3/4"

WALL FASTENERS:

- AT 32" ON CENTER
- Ø3/8" x 3-1/2" SIMPSON WEDGE-ALL,
- MIN. 3000 PSI CONCRETE REQ'D
- MIN. EMBEDMENT DEPTH - 2-5/8"

ASSEMBLY FASTENERS:

- AT 36" ON CENTER
- Ø3/8-16 x 1-1/2" HEX HEAD CAP SCREW, GR. 5
- HEX HEAD NUT, GR. 5
- HARDENED FLAT WASHERS

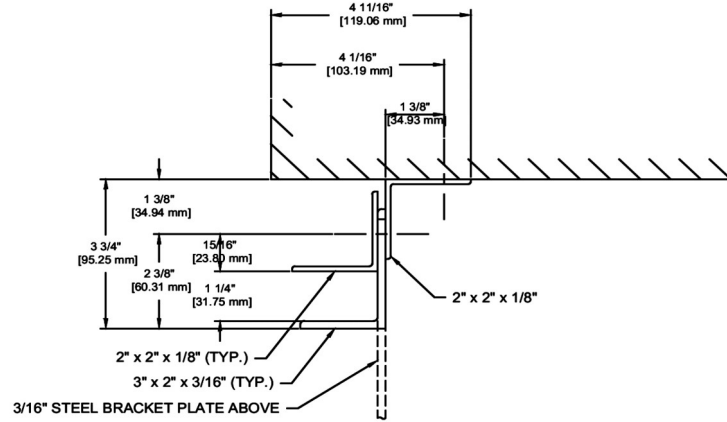

GA0351 - 3 3/4"

WALL FASTENERS:

- AT 32" ON CENTER
- Ø3/8" x 3-1/2" SIMPSON WEDGE-ALL,
- MIN. 3000 PSI CONCRETE REQ'D
- MIN. EMBEDMENT DEPTH - 2-5/8"

ASSEMBLY FASTENERS:

- AT 36" ON CENTER
- Ø3/8-16 x 1-1/2" HEX HEAD CAP SCREW, GR. 5
- HEX HEAD NUT, GR. 5
- HARDENED FLAT WASHERS

C20P SLAT

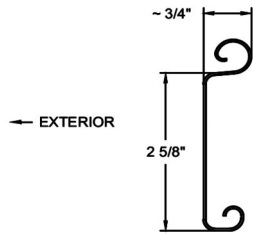

**MK: 001
PLAN OF OPENING**

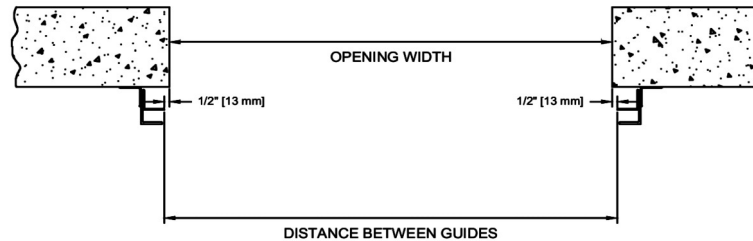

INSTALLERS NOTE:

MAINTAINING FACTORY SET GUIDE GAPS IS CRITICAL TO THE PROPER OPERATION OF THE DOOR AND IT'S ABILITY TO WITHSTAND THE DESIGNED WINDLOAD!

ENDLOCK DETAIL

C417P MOLDED NYLON ENDLOCK ON ALTERNATING SLATS WITH 2 x 1/4" RIVETS

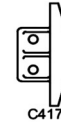

04-09-2018	PRODUCT CODE:		
QS1_375	CFI 5F 22GP		
---	ORIGINAL DRAWING	06/13/18	MX
#	REVISION	DATE	BY



**SERVICE DOOR GUIDE ASSEMBLY
3-3/4" PACKOFF**

JOB:
TO ADVISE

MODEL #:	ESD10	JOB #:	E 01236316 001 B *
AGENT:	MEXICO		
CONTRACTOR:			
ARCHITECT:			



(229) 365-5662

portonesautomaticos@adsver.com.mx
portonesautomaticos@prodigy.net.mx

