



Puertas & Portones Automaticos, S.A. de C.V.

¡Nuestra pasión es la Solución!....

MOTOR SPECIFICATIONS:

1/3 HP motor to include a TENV motor, reversing magnetic controller in NEMA 1 enclosure, planetary gearbox for drive reduction, electric brake and an auxiliary chain operator. Includes UL listed thermal overload protection, rotary limit switches, safety edge circuit and transformer with 24 volt control secondary, and delay on reverse. Pre-wired to a terminal block using color coding of the wires to facilitate troubleshooting.

CURRENT CHARACTERISTICS:

220V 1 PH 60HZ

Electrical current must be verified in writing before job is released for manufacture; current verified and found correct. Operator bracket bracing required, unless operator is wall mounted.

Signed:

ELECTRICAL EQUIPMENT LIST:

1 - Three button push button station 'OPEN-CLOSE-STOP' in NEMA 1 enclosure, surface mounted.

BOTTOM BAR LOCKING:

QUANTITY & MARK:

(1) 001

MATERIAL & FINISH:

Front slat - Galvanized steel with GalvaNex™ coating system.

Finish color: Gray

Back slat - Galvanized steel with GalvaNex™ coating system.

Finish color: Gray

Bottom Bar - Extruded aluminum, mill finish

Guides - Structural steel, Gray polyester powder coating

Hood - Galvanized steel with GalvaNex™ coating system.

Finish color: Gray

Plain Steel - Powder coated gray

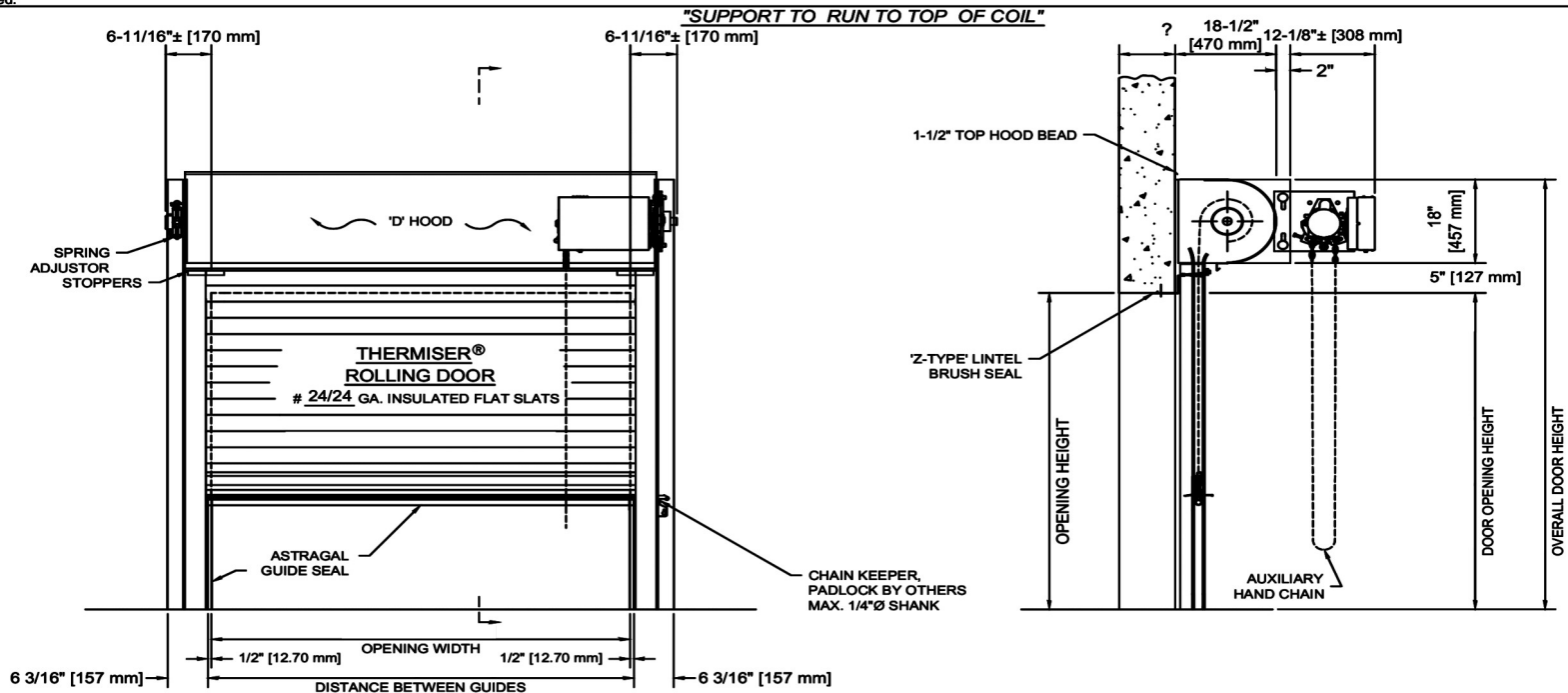

05-22-2018	PRODUCT CODE:		
MTR_STDR	MFV 6F 44GP		
---	ORIGINAL DRAWING	10/03/18	MX
#	REVISION	DATE	BY

ELEVATION (COIL SIDE) AND SECTION VIEW

See drawing # E 01248776 001 B for guide detail.



MGH MOTOR OPERATED ROLLING DOOR	
JOB:	INSULATED DOORS

MODEL #:	ESD20	JOB #:	E 01248776 001 A
AGENT:	MEXICO		
CONTRACTOR:			
ARCHITECT:			



RESIDENCIAL



COMERCIAL



INDUSTRIAL



(229) 365-5662

portonesautomaticos@adsver.com.mx
portonesautomaticos@prodigy.net.mx



Puertas & Portones Automaticos, S.A. de C.V.

¡Nuestra pasión es la Solución!...

NOTE: Wall construction detail shown is for illustrative purposes only, does not imply compliance with building requirements, and must meet architectural specifications to properly support product. Products designed with wind load requirements must be properly fastened to structural members as specified in order to avoid catastrophic failure. Wall construction and closure installation shall be in accordance with the local authority having jurisdiction requirements.

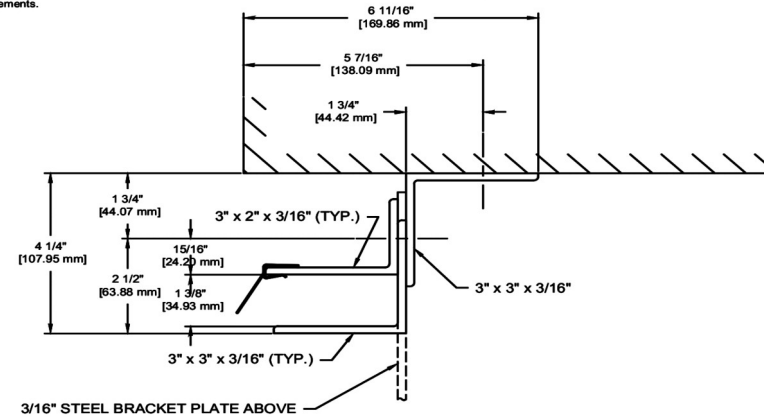
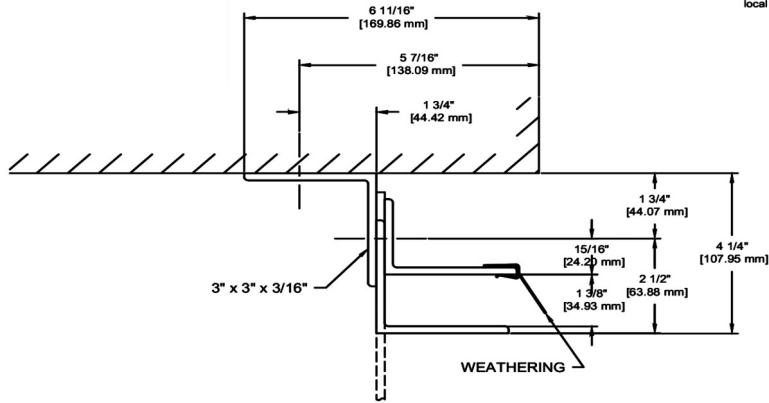

GA0414 - 4 1/4"

WALL FASTENERS:

- AT 29" ON CENTER
- Ø3/8" x 3-1/2" SIMPSON WEDGE-ALL, MIN. 3000 PSI CONCRETE REQ'D
- MIN. EMBEDMENT DEPTH - 2-5/8"

ASSEMBLY FASTENERS:

- AT 36" ON CENTER
- Ø3/8-16 x 1 1/2" HEX HEAD CAP SCREW, GR. 5
- HEX HEAD NUT, GR. 5
- HARDENED FLAT WASHERS

GA0414 - 4 1/4"

WALL FASTENERS:

- AT 29" ON CENTER
- Ø3/8" x 3-1/2" SIMPSON WEDGE-ALL, MIN. 3000 PSI CONCRETE REQ'D
- MIN. EMBEDMENT DEPTH - 2-5/8"

ASSEMBLY FASTENERS:

- AT 36" ON CENTER
- Ø3/8-16 x 1 1/2" HEX HEAD CAP SCREW, GR. 5
- HEX HEAD NUT, GR. 5
- HARDENED FLAT WASHERS

BOTTOM BAR / SLAT DETAIL

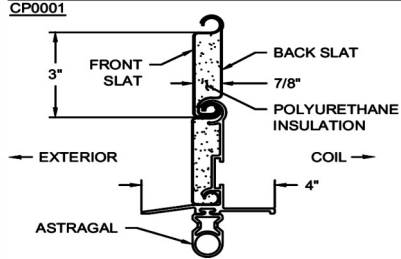

MK: 001 PLAN OF OPENING

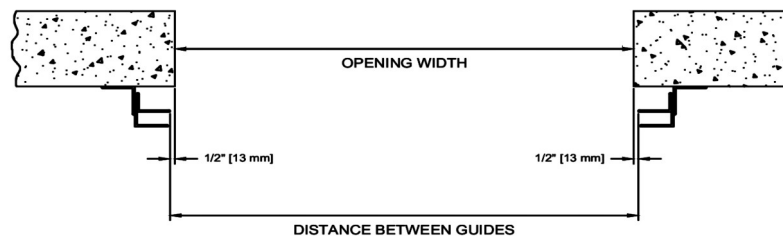

INSTALLERS NOTE:
MAINTAINING FACTORY SET GUIDE GAPS IS CRITICAL TO THE PROPER OPERATION OF THE DOOR AND ITS ABILITY TO WITHSTAND THE DESIGNED WINDLOAD!

ENDLOCK DETAIL

CP0407 MOLDED NYLON ENDLOCK ON ALTERNATING SLATS WITH 2 x 1/4" RIVETS.



CP0407

06-15-2016	PRODUCT CODE:
TD7_425	MFW 6F 44GP
---	ORIGINAL DRAWING
#	REVISION

10/03/18	DATE
MX	BY



INSULATED SERVICE DOOR GUIDE ASSEMBLY, 4-1/4" PACKOFF

JOB: INSULATED DOORS

MODEL #:	ESD20	JOB #:	E 01248776 001 B
AGENT:	MEXICO		
CONTRACTOR:			
ARCHITECT:			

(229) 365-5662
portonesautomaticos@adsver.com.mx
portonesautomaticos@prodigy.net.mx

