



» PUERTA DE TRAFICO PHOENIX MOD.HAWK SOLID CORE.

Hawk Series: Solid Core

Metal or Laminate Clad Traffic Door



Shown in aluminum w/
48" stainless steel kick plate

The Hawk Series - Solid Core traffic doors are constructed with a composite wood core bonded with sheets of aluminum, stainless steel, or laminate. These sleek, stout doors are ideal for cafes, restaurants, and hotels.

- ✓ Rigid wood core construction is clad with High Pressure Laminate (HPL), Aluminum (AC) or Stainless Steel (SS)
- ✓ Stainless steel hinges are standard
- ✓ Smooth swing action hinge
- ✓ Stainless steel edge capping protects entire door perimeter
- ✓ Ability to affix locking mechanism for security
- ✓ Full perimeter, extruded blade gasket available
- ✓ Sleek and attractive, high-end finish
- ✓ High Pressure Laminate is available in over 600 decorative finishes, including granites, metallic colors and woodgrains



Shown in stainless steel



Shown in aluminum w/ 48" stainless steel kick plates

(229) 288-1552

portonesautomaticos@adsver.com.mx
portonesautomaticos@prodigy.net.mx



V03.19



PHOENIX
DOOR SYSTEMS



Puertas & Portones Automáticos, S.A. de C.V.
¡Nuestra pasión es la Solución!...

» PUERTA DE TRAFICO PHOENIX MOD.HAWK SOLID CORE.

Hawk Series: Solid Core

Metal or Laminate Clad Traffic Door

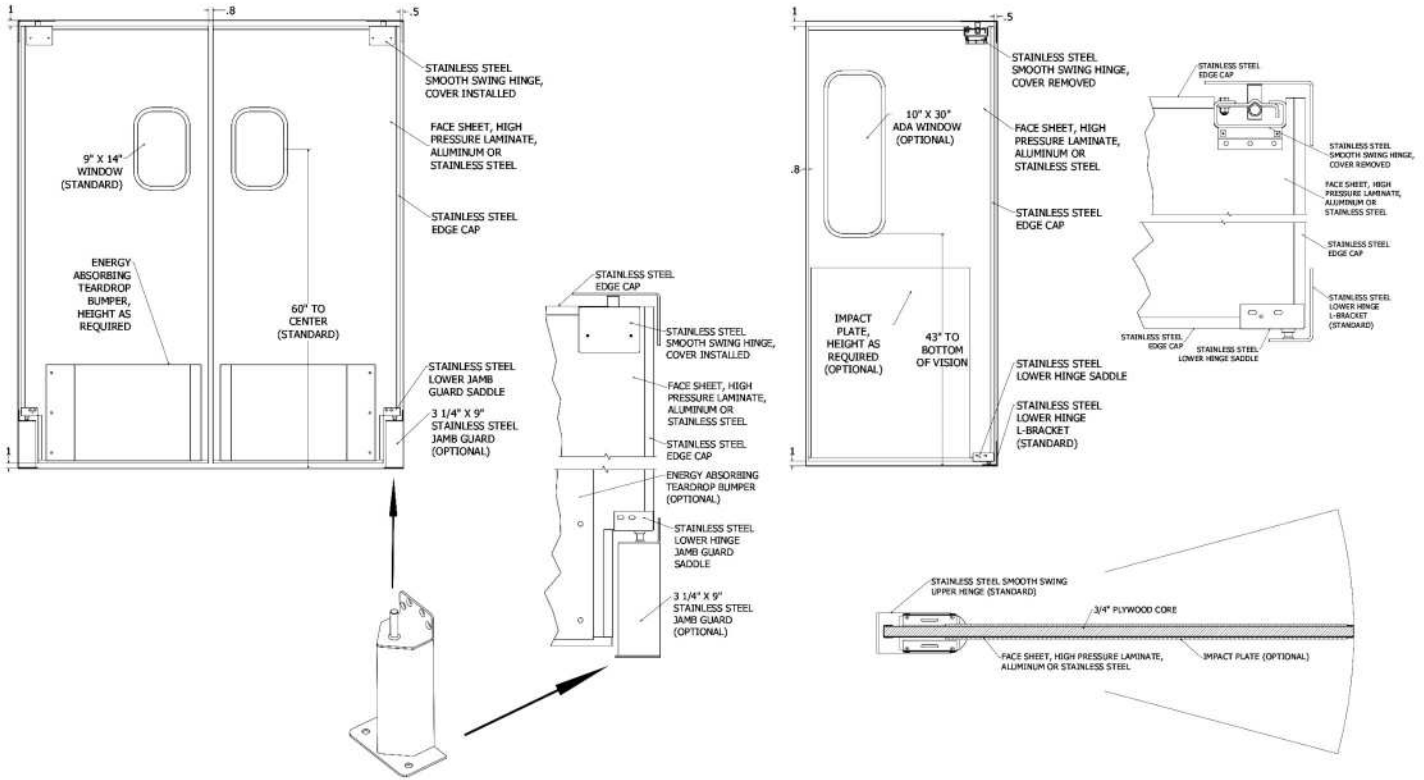

Specifications

Series / Models:	Hawk / HPL, AC, SS
Sizes:	24" - 48" wide and up to 96" high
Core:	Domestic high quality 3/4" thick 7-layer plywood
Surface:	Full height laminate, aluminum, or stainless steel cladding (both sides)
Perimeter Edge:	18-gauge stainless steel cap
Hinge:	Stainless steel smooth swing / Bottom L-bracket
Window:	Standard 9" x 14" acrylic, set in black rubber self-locking molding
Warranty:	2-year against manufacturer defects

Options:

Window sizes:	14" x 16", 10" x 30" (ADA) and 12" round
Kick plates:	Stainless steel or black ABS in 12", 18", 24", 36" and 48"
Bumpers:	Polyethylene teardrop in 12", 18", 24", 36", 42" and 48"
Bottom hinge	3" x 9" stainless steel lower jamb guard
Gasket:	Full-perimeter, extruded blade gasket

Popular Surfaces



Available in over 600 laminate finishes.



V03.19

(229) 288-1552

portonesautomaticos@adsver.com.mx
portonesautomaticos@prodigy.net.mx



(229) 927-5107, 167-8080, 167-8007, 151-7529.



www.adsver.com.mx



» PUERTA DE TRAFICO PHOENIX MOD.HAWK SOLID CORE.

STOCK LAMINATES
SOLID COLORS – MATTE FINISH

Hawk Series: Solid Core

Metal or Laminate Clad Traffic Door

*Pattern images are representative samples. Color may differ slightly from actual product.



GRAPHITE



SPECTRUM RED



SPECTRUM BLUE



DESERT BEIGE



PLATINUM



BLACK



STORM



ALMOND



ANTIQUÉ WHITE



WHITE



FOG



DARK CHOCOLATE



HUNTER GREEN



CLASSIC WHITE





» PUERTA DE TRAFICO PHOENIX MOD.HAWK SOLID CORE.

WOOD GRAINS – MATTE FINISH

Hawk Series: Solid Core

Metal or Laminate Clad Traffic Door



NATURAL OAK



NATURAL MAPLE



BLOSSOM CHERRYWOOD



VOSGES PEAR



WILD CHERRY



PRESTIGE WALNUT



VICTORIAN MAHOGANY



SELECT CHERRY



BANNISTER OAK



BILTMORE CHERRY



BUKA BARK



FONTHILL PEAR



MANITOBA MAPLE



NEOWALNUT



PEWTER BRUSH



GUNSTOCK WALNUT

